

How to Collect a Vaginal Sample Using the Aptima[®] Multitest Swab Specimen Collection Kit

General Information

A vaginal swab sample is one option to test for vaginal infections. Talk with your health care provider if you:

- have questions about how to do the sample
- want more information on other sample collection options
- have questions about vaginal infections.

Collecting A Vaginal Sample

Your health care provider will describe how to collect the sample. Read these instructions. Tell your health care provider if you think you can do the sample collection by yourself. Do not take the collection kit or your sample out of the clinic.

What To Tell Your Health Care Provider

Before you collect a vaginal swab sample tell your health care provider if you:

- are pregnant
- have had recent pelvic pain
- have pain with sexual intercourse
- have unusual vaginal discharge or odor.

Before Opening Your Kit

Read all of the instructions before collecting your vaginal swab sample. It is important to follow the instructions so the sample is collected the right way. This will help your test results be correct.

Before you get started:

- Ask for a pen to add your name to the sample tube.
- Wash your hands well.
- Undress as needed in the exam room or restroom.
- Move into a comfortable position that helps you maintain your balance while you collect the sample.

How to Collect Your Sample

- Open the swab package (drawing 1).

— Remove the swab. Do not touch the soft tip or lay the swab down.

— If you touch the soft tip, lay down or drop the swab, ask for a new Aptima Multitest

Swab Specimen Collection Kit.

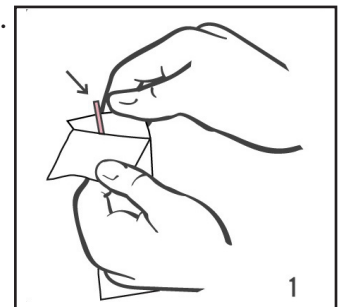

(over)

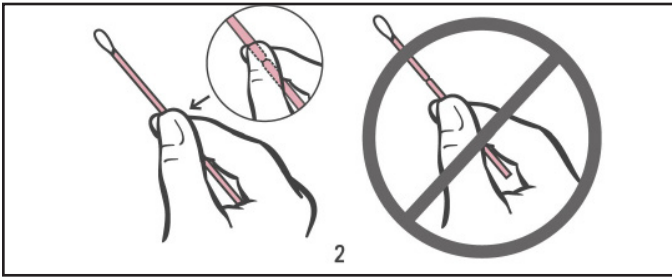

- Hold the swab in your hand (drawing 2).
 - Place your thumb and forefinger in the middle of the swab covering the black (score) line.
 - Do not hold the swab below the score line.

- Carefully insert the swab about 2 inches (5 centimeters) inside the opening of your vagina (drawing 3).

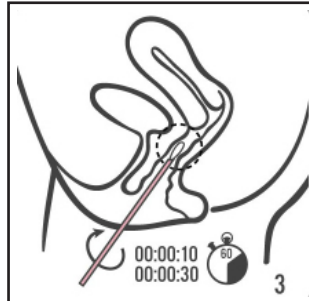

- Gently rotate the swab for 10 to 30 seconds (drawing 3). Make sure the swab touches the walls of the vagina so that moisture is absorbed by the swab.

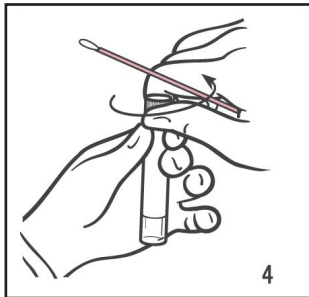

- Pull out the swab without touching the skin.

- While holding the swab, unscrew the cap from the tube (drawing 4).

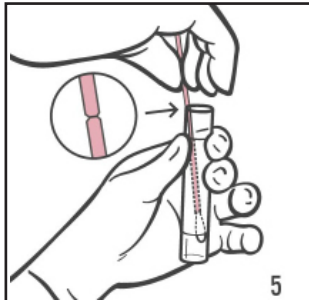

- Place the swab into the tube with the score line at the top of the tube (drawing 5).

- Carefully break the swab shaft at the score line against the side of the tube (drawing 6).

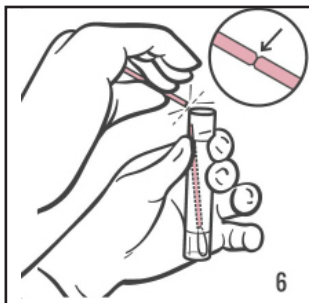

- Throw away the top of the swab shaft (drawing 7).
- Tightly screw the cap onto the tube (drawing 8).
- Write your full name and date of birth on the tube.
- Return the tube as instructed by your health care provider.

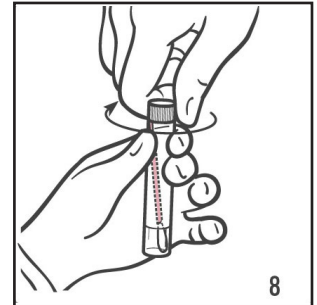
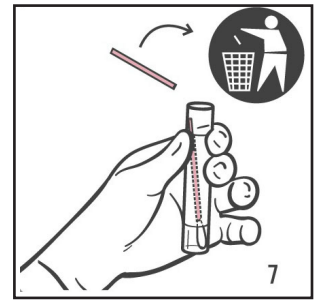

WARNING:

If the contents of the tube spill ask for a new Aptima Multitest.

If the contents get on your skin, wash the area with soap and water.

If the contents of the tube splash in your eyes, flush your eyes with water right away. Call your health care provider if your eyes become red and irritated.

Aptima is a registered trademark of Hologic, Inc. Images provided as a courtesy by Hologic, Inc.